



PRODUCT NAME	MODEL NO. ALV510F3-QC9
Medium Flow Rate Ex d Pilot Solenoid Valve	
DESCRIPTION OF THE PRODUCT	

ALV510F3-QC9 series pilot action flameproof solenoid valve is composed of flameproof direct acting solenoid valve module and 510F3 series pneumatic valve module. Large voltage selection range, convenient wiring, good flameproof performance and good valve body flow rate are the main advantages of this kind of solenoid valve. In addition, armed with the namur adapter plates, this solenoid valve can easily realize the conversion of 3/2 and 5/2 functions.

APPROVED BY	Coil Specification: QC9 (ALV110Q1C9)	
	Coil Enclosure	Die-casting aluminum + Epoxy coated
	Wiring Connector	M20-1.5 or 1/2"NPT, Terminal Strip

BODY TECHNICAL DATA	
Body	Extruded aluminum + anodized coated
Seal	Buna N
Fasteners	Stainless steel
Function	5/2 or 3/2NC, Monostable
Flow rate(Orifice)	CV=1.1 (19.63mm ²)
Air Ports	G1/4" or NPT
Manual Override	on the body
Mounting	Namur Face (24×32)
Working pressure	2~8 bar
Working Medium	less than 40µm filtered and dried air
Working Temp.	-20℃~60℃ (optional: -40℃~60℃)
Environment.	Indoor and Outdoor
Weather Proof	IP67

Operating Voltage	24VDC±10% ≤1W, 110/220VDC±10% ≤3.5W 24/110/220VAC±10% ≤ 4VA(50/60Hz)
Voltage Tolerance	±10%
Insulation Protection	H class
Insulated voltage	1000V
Duty factor	100% ED
Area Classification	Ex db IIC T6 Gb, Ex tb IIIC T85℃ Db

Wiring Diagram and Operating

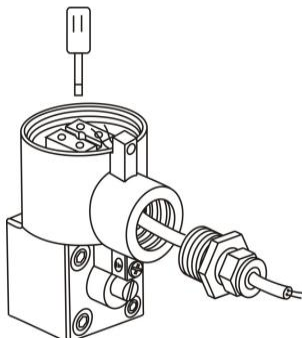

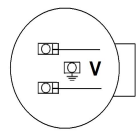

Note: The Exd Cable Gland is not included. Enquiry please contact with us.

DIMENSION AND DRAWING

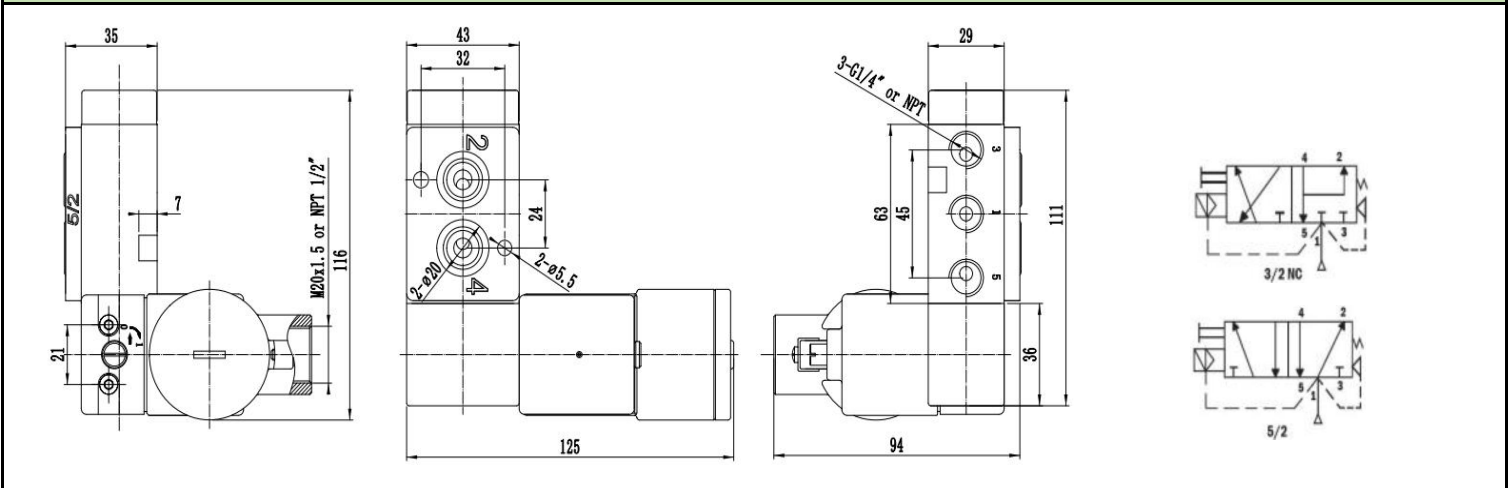

*For continuous improvement of the product, we reserve the right to alter the dimensions, technical data in this data sheet.